

## Sealed Road Network Summary

Road Name	From	To	Categorey	Length (kms)	Width (mtrs)
Mangalo Cleve	Mangalo	Council Boundary	Rural Sealed	11.5	9
Balumbah-Kinnaird Rd.	Boundary(Sth)	Boundary(Nth)	Rural Sealed	73.0	9
Mangalo Rd.	Cleve	Franklin Harbour	Rural Sealed	8.9	7.7
Five x Roads	Lincoln Highway	Verran Rd.	Rural Sealed	2.0	7.2
Red Banks Rd	Lincoln	Carpark Area	Rural Sealed	1.0	9
Tel el Kebir Tce.	Lincoln Highway	Creek Rd.	TS Cat 1	1.3	9.2
Darke Tce.	Howard St.	Theakston Tce.	TS Cat 1	0.5	7.2
Railway Tce.	Birdseye Highway	Balumbah-Kinnaird	TS Cat 1	0.7	7.4
Wake Rd.	Birdseye Highway	Hauschild Rd.	TS Cat 1	0.8	7.2
Blomberry Rd.	Ciaro Tce.	Cemetery	TS Cat 2	1.0	7.7
Park lane	Creek Rd.		TS Cat 2	0.1	9.2
Creek Rd.	Tel el Kebir Tce.		TS Cat 2	1.0	9.2
Barnes Lane	Tel el Kebir Tce.		TS Cat 2	0.7	19.2
Sunrise Drive	Barnes Lane		TS Cat 2	0.9	8.2
Centenery Lane			TS Cat 2	0.4	6.7
Ciaro Tce.	Tel el Kebir Tce.	Ismalia Tce.	TS Cat 2	0.5	8.2
Third St.	Tel el Kebir Tce.	Ismalia Tce.	TS Cat 2	0.5	9.2
Fourth St.	Tel el Kebir Tce.	Ismalia Tce.	TS Cat 2	0.5	9.2
Alexandria Tce.	Tel el Kebir Tce.	Ismalia Tce.	TS Cat 2	0.5	9.2
Ismalia Tce.	Ciaro Tce.	Alexandria Tce.	TS Cat 2	0.5	7.2
Second St.	Ciaro Tce.	Alexandria Tce.	TS Cat 2	0.5	9.2
High St.	Ciaro Tce.	Alexandria Tce.	TS Cat 2	0.5	9.2
First St.	Ciaro Tce.	Alexandria Tce.	TS Cat 2	0.5	9.2
Theakston Tce.	Darke Tce.	Henry St.	TS Cat 2	0.3	7.2
Charles St.	Darke Tce.	Henry St.	TS Cat 2	0.1	7.2
John St.	Darke Tce.	Henry St.	TS Cat 2	0.1	7.2
Howard St	Darke Tce.	Henry St.	TS Cat 2	0.1	7.2
Henry St.	Howard St.	Theakston Tce.	TS Cat 2	0.5	6.7
Poyntz Tce.	Railway Tce.	Bruce Tce.	TS Cat 2	0.1	7.2
High St.	Poyntz Tce.	First St.	TS Cat 2	0.3	7.2

Second St.	Railway Tce.	High St.	TS Cat 2	0.1	7.2
First St.	Railway Tce.	High St.	TS Cat 2	0.1	7.2
Pearce Cres.	Airport Rd.	Sims Cres.	TS Cat 2	0.1	8.7
Sims Cres.	Edwards Tce.	South Tce.	TS Cat 2	0.3	8.7
Leonard Cres.	Edwards Tce.	Sims Cres.	TS Cat 2	0.1	9.2
Traeger St.	Airport Rd.	Angwane St.	TS Cat 2	0.6	8.7
Gillings St.	Arno Bay Service Rd.	Traeger St.	TS Cat 2	0.2	8.7
Angwane St.	Arno Bay Service Rd.	Traeger St.	TS Cat 2	0.2	8.7
Serotzki St.	Cleve/Arno Bay Rd.	End	TS Cat 2	0.2	7.2
Arno Bay Service Road - Elsom			TS Cat 2	0.5	7.2
Arno Bay Service Road - Airport			TS Cat 2	0.5	7.2
Forbes St	Cleve/Arno Bay Rd.	End	TS Cat 2	0.3	6.6
Stubing St.	Cleve/Arno Bay Rd.	End	TS Cat 2	0.3	6.6
Price St.	Stubing St.	Forbes St.	TS Cat 2	0.1	6.6
Depot St.	Brookes St.	Wake Rd.	TS Cat 2	0.3	7.7
Brookes St	Golf Drive	Birdseye Highway	TS Cat 2	0.3	8.7
Golf Drive	West Tce.	Wake Rd.	TS Cat 2	0.8	7.2
Fitzgerald St.	Golf Drive	Birdseye Highway	TS Cat 2	0.2	7.7
West Tce.	North Tce	South Tce.	TS Cat 2	0.8	12.5
Fifth St.	North Tce	birdseye highway	TS Cat 2	0.3	13.2
Third St.	North Tce	Mitchell Tce	TS Cat 2	1.2	11.7
Fourth St.	birdseye highway	Main St	TS Cat 2	0.3	16.7
East Tce.	North Tce	South Tce.	TS Cat 2	1.2	17.2
North Tce	West Tce.	East Tce.	TS Cat 2	0.3	7.7
South Tce.	West Tce.	East Tce.	TS Cat 2	0.7	11.2
Edwards Tce.	Airport Rd.	Mitchell St.	TS Cat 2	0.9	8.2
Airport Rd.	Cleve/Arno Bay Rd.	Edwards Tce.	TS Cat 2	0.5	9.2
Potter Place	East Tce.		TS Cat 2	0.1	9.2
Silver St.	White St.	Edwards Tce.	TS Cat 2	0.3	9.2
Whyte St.	East Tce.	Edwards Tce.	TS Cat 2	0.2	10.2
First St.	West Tce.	East Tce.	TS Cat 2	0.5	13.2
Second St.	West Tce.	East Tce.	TS Cat 2	0.5	13.2

Hendersen Ave.	Birdseye Highway		TS Cat 2	0.3	9.2
Elson Ave	East Tce.	Henderson Ave.	TS Cat 2	0.1	9.2

## Unsealed Road Network Summary

Road name	From	To	From Chain	To Chain	Cat	Length	Width
Burton	Mangalo Kielpa	John Burton	-	3,570	1	3.6	9
Burton	John Burton	COS	3,570	4,907	1	1.3	9
Burton	COS	Watchanie	4,907	6,487	1	1.6	9
Cowell Mangalo	Council Boundary	Picnic/Ricketts	-	2,620	1	2.6	9
Cowell Mangalo	Picnic/Ricketts	Bridge	2,620	7,070	1	4.5	9
Cowell Mangalo	Bridge	Burton	7,070	7,417	1	0.3	9
Heggaton	Mangalo Kielpa	EOS (dam)	-	2,500	1	2.5	9
Heggaton	EOS (dam)	Butler	2,500	3,414	1	0.9	9
Heggaton	Butler	Farm Gate	3,414	5,704	1	2.3	9
Heggaton	Farm Gate	Wetheralls	5,704	7,923	1	2.2	9
Heggaton	Wetheralls	EOS	7,923	9,923	1	2.0	9
Heggaton	EOS	Jones	9,923	11,380	1	1.5	9
Heggaton	Jones	Pushbike Corner	11,380	15,100	1	3.7	9
Heggaton	Pushbike Corner	Hen and Chicken	15,100	19,691	1	4.6	9
Heggaton	Hen and Chicken	Dogfence	19,691	20,969	1	1.3	9
Heggaton	Dogfence	Council Bdry	20,969	23,249	1	2.3	9
Mangalo Kielpa	Cleve Kimba	Heggaton	-	4,330	1	4.3	9
Mangalo Kielpa	Heggaton	Bend R	4,330	7,192	1	2.9	9
Mangalo Kielpa	Bend R	EOS	7,192	10,204	1	3.0	9
Mangalo Kielpa	EOS	Burton	10,204	12,994	1	2.8	9
Verran Rd	Cleve/Verran Rd	5 x Roads	-	2,000	Ruo1	2.0	9
Verran Rd	Cleve/Verran Rd	5 x Roads	2,000	7,000	Ruo1	5.0	9
Verran Rd			7,000	13,000	Ruo1	6.0	9
Verran Rd	Cleve/Verran Rd	5 x Roads	13,000	21,000	Ruo1	8.0	9
Old Main Rd	Cleve/Arno Bay Rd	Cleve/Cowell Rd	-	15,800	Ruo1	15.8	9
Cleve/Verran Rd	Balumba-Kinnard Rd	Veran	1,200	6,800	Ruo1	5.6	9
Cleve/Verran Rd	Balumba-Kinnard Rd	Veran	-	1,200	Ruo1	1.2	9
Schmitt Rd	Lincoln Highway	Cleve-Arno Bay Rd	-	1,400	Ruo1	1.4	9
Wudinna - Darke Peak Rd	Balumbah-Kinnaird	Edwards Rd	-	19,600	Ruo1	19.6	9
Dogfence Rd			-	12,000	Ruo1	12.0	9
Dogfence Rd			12,000	14,500	Ruo1	2.5	9
Dogfence Rd			14,500	18,500	Ruo1	4.0	9
Dogfence Rd			18,500	23,200	Ruo1	4.7	9
Dogfence Rd			23,200	29,500	Ruo1	6.0	9
Five x Roads	Lincoln Highway	Arno Bay/Verran Rd	-	4,200	Ruo1	4.2	9
Pump Station Rd	Cleve-Arno Bay Rd	Arno Bay/Verran Rd	-	8,400	Ruo1	8.4	9
Carappee Hill Rd	Cleve-Kimba Rd	Balumbah-Kinnaird Rd	-	15,000	Ruo1	15.0	9

Carapee Hill Rd	Cleve-Kimba Rd	Balumbah-Kinnaird Rd	15,000	18,000	Ruo1	3.0	9
Carapee Hill Rd	Cleve-Kimba Rd	Balumbah-Kinnaird Rd	18,000	22,100	Ruo1	4.1	9
Cleve/Verran Rd			6,800	13,800	Ruo1	7.0	9
Cleve/Verran Rd			13,800	20,300	Ruo1	6.5	9
Poolgara-Darke Peak Rd			3,000	4,800	Ruo1	1.8	9
Poolgara-Darke Peak Rd			-	3,000	Ruo1	3.0	9
Old Darke Peak Rd			12,000	15,000	Ruo2	3.0	8
Old Darke Peak Rd			15,000	18,000	Ruo2	3.0	8
Rehn Rd			-	5,000	Ruo2	5.0	8
Rehn Rd			5,000	6,500	Ruo2	1.5	8
Carpa Rd			-	5,900	Ruo2	5.9	8
Wake Rd			-	5,900	Ruo2	5.9	8
Price Rd			-	1,300	Ruo2	1.3	8
Kielpa-Kilroo Rd			-	12,400	Ruo2	12.4	8
Rangeview Rd			-	17,200	Ruo2	17.2	8
O'Connor Rd			-	10,800	Ruo2	10.8	8
Rocky Corner Road			-	4,000	Ruo2	4.0	8
Swaffer Rd			-	2,000	Ruo2	2.0	8
Swaffer Rd			2,000	5,000	Ruo2	3.0	8
Swaffer Rd			5,000	8,000	Ruo2	3.0	8
Swaffer Rd			8,000	10,000	Ruo2	2.0	8
Master Rd			-	2,500	Ruo2	2.5	8
Master Rd			11,700	12,600	Ruo2	0.9	8
Master Rd			2,500	8,300	Ruo2	5.8	8
Master Rd			12,600	14,600	Ruo2	2.0	8
Master Rd			14,600	16,600	Ruo2	2.0	8
Schubert Rd			-	6,100	Ruo2	6.1	8
Plane Rd			-	5,000	Ruo2	5.0	8
Plane Rd			5,000	8,000	Ruo2	3.0	8
Plane Rd			8,000	10,700	Ruo2	2.7	8
Plane Rd			10,700	14,400	Ruo2	3.7	8
Plane Rd			14,400	23,800	Ruo2	9.4	8
Blomberry Rd			-	2,000	Ruo2	2.0	8
Kielpa-GumFlat Rd			-	20,500	Ruo2	20.5	8
Old Darke Peak Rd			-	12,000	Ruo2	12.0	8
Old Darke Peak Rd			18,000	26,800	Ruo2	8.8	8
Syvertsen Ave.	Birdseye Highway	Balumbah-Kinnaird	-	19,800	Ruo2	19.8	8
Quinn Rd	Birdseye Highway	Syvertsen Rd	-	5,800	Ruo2	5.8	8

Murlong-murdinga Rd	Birdseye Highway	Elliston Boundary	-	6,200	Ruo2	6.2	8
Murlong-murdinga Rd	Birdseye Highway	Elliston Boundary	6,200	11,100	Ruo2	4.9	8
Tooligie Rd	Murlong-Murdinga Rd	Elliston Boundary	-	9,200	Ruo2	9.2	8
Pahls Hill Rd	Balumbah-Kinnaird Rd	Masters Rd	-	10,700	Ruo2	10.7	8
Wharminda Rd	Masters Rd	5 x Roads	-	25,300	Ruo2	25.3	8
Davis Rd	Cutline Rd	Hean Rd	-	6,000	Ruo3	6.0	8
Davis Rd	Hean Rd	Balumbah Kinnaird Rd	6,000	11,400	Ruo3	5.4	8
Cleanseas Rd			-	1,100	Ruo3	1.1	8
Cleanseas Rd			1,100	2,100	Ruo3	1.0	8
Syvertsen Ave.			-	1,800	Ruo3	1.8	8
Boakes Drive			-	900	Ruo3	0.9	8
			-	1,300	Ruo3	1.3	8
			-	1,600	Ruo3	1.6	8
			-	10,700	Ruo3	5.0	8
	Cleve-Kimba Rd	Syvertsen Rd	-	3,300	Ruo3	3.3	8
	Birdseye Highway	Price Rd	-	2,300	Ruo3	2.3	8
	Birdseye Highway	Cleve/Verran Rd	-	4,800	Ruo3	4.8	8
Lock-Darke Peak			-	14,400	Ruo3	14.4	8
Lock-Darke Peak			19,200	21,200	Ruo3	2.0	8
Lock-Darke Peak			17,200	19,200	Ruo3	2.0	8
		Birdseye Highway	-	5,500	Ruo3	5.5	8
		Darke Peak-Lock	-	13,000	Ruo3	13.0	8
	Dogfence Rd	Morrow Rd	-	3,000	Ruo3	3.0	8
	Dogfence Rd	Morrow Rd	3,000	8,000	Ruo3	5.0	8
		Oconnor Rd	-	12,200	Ruo3	12.2	8
	Giles Rd	Birdseye Highway	-	6,900	Ruo3	6.9	8
Hampel Rd	Swaffer Rd	Nield Rd	-	9,300	Ruo3	9.3	8
Chappell Rd	Masters Rd	Hampel Rd	-	10,900	Ruo3	10.9	8
South Spriggs Rd	Birdseye Highway	Price Rd	-	4,700	Ruo3	4.7	8
Scenic (Ramsey)			-	1,900	Ruo3	1.9	8
Wangaraleednie Rd	Birdseye Highway	Scenic	-	6,100	Ruo3	6.1	8
Harradine Rd	Wardle Rd	Boundary	-	4,200	Ruo3	4.2	8
Ross Ramsey Rd	Carappee hill Rd	Schubert Rd	-	3,000	Ruo3	3.0	8
Picnic	Cowell Mangalo	EOS			formed	2.5	5
Picnic	Cowell Mangalo	EOS			formed	2.5	5
Picnic	EOS	Farm Gate			formed	1.8	4
Picnic	EOS	Farm Gate			formed	1.8	4
Picnic	Farm Gate	Council Bdry			formed	1.7	5

Picnic	Farm Gate	Council Bdry	formed	1.7	5
Jamieson Tank Rd	Kimba/CleveRd	Cutline Rd	formed	9.5	7
Jamieson Tank Rd	Kimba/CleveRd	Cutline Rd	formed	9.5	7
Wudinna Rd	Hebbermann	Edwards Rd	formed	9.1	8
Wudinna Rd		Edwards Rd	formed	9.1	8
Wudinna Rd	Hebbermann	Rangeview Rd	formed	12.0	7
Wudinna Rd		Rangeview Rd	formed	12.0	7
Kielpa-Mangalo Rd	Cleve-Kimba Rd	Boundary	formed	0.5	8
Kielpa-Mangalo Rd	Cleve-Kimba Rd	Boundary	formed	0.5	8
Yeldulknie Rd	Birdseye Highway	Weir	formed	0.7	6
Kielpa/Mangalo Rd	Mangalo Rd	Mid Rd (Cleve/Kimba)	formed	3.0	9

# District Council of Cleve Rural Roads

# RACK PLAN 984

### ROAD TABLE

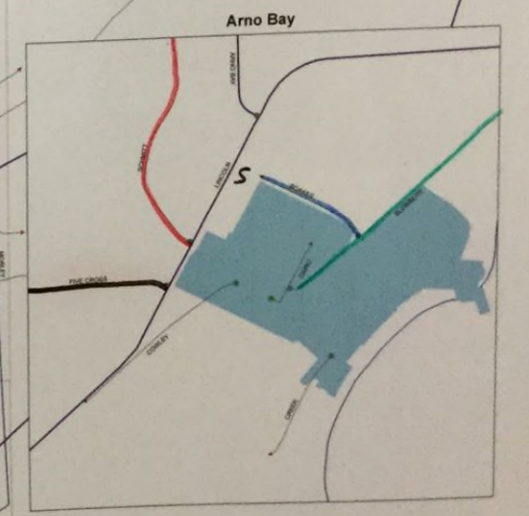

ROAD	ROAD
ALBERT ROAD	100
ALICE ROAD	101
ANDREW ROAD	102
ANNIE ROAD	103
ANTHONY ROAD	104
ARNO ROAD	105
AUGUST ROAD	106
AUNT JANE ROAD	107
AUNT MARY ROAD	108
AUNT SARAH ROAD	109
AUNT THOMAS ROAD	110
AUNT WILLIAM ROAD	111
AUNT YOUNG ROAD	112
AUNT ZOE ROAD	113
AUNT ELIZABETH ROAD	114
AUNT MARGARET ROAD	115
AUNT ANN ROAD	116
AUNT JANE ROAD	117
AUNT MARY ROAD	118
AUNT SARAH ROAD	119
AUNT THOMAS ROAD	120
AUNT WILLIAM ROAD	121
AUNT YOUNG ROAD	122
AUNT ZOE ROAD	123
AUNT ELIZABETH ROAD	124
AUNT MARGARET ROAD	125
AUNT ANN ROAD	126
AUNT JANE ROAD	127
AUNT MARY ROAD	128
AUNT SARAH ROAD	129
AUNT THOMAS ROAD	130
AUNT WILLIAM ROAD	131
AUNT YOUNG ROAD	132
AUNT ZOE ROAD	133
AUNT ELIZABETH ROAD	134
AUNT MARGARET ROAD	135
AUNT ANN ROAD	136
AUNT JANE ROAD	137
AUNT MARY ROAD	138
AUNT SARAH ROAD	139
AUNT THOMAS ROAD	140
AUNT WILLIAM ROAD	141
AUNT YOUNG ROAD	142
AUNT ZOE ROAD	143
AUNT ELIZABETH ROAD	144
AUNT MARGARET ROAD	145
AUNT ANN ROAD	146
AUNT JANE ROAD	147
AUNT MARY ROAD	148
AUNT SARAH ROAD	149
AUNT THOMAS ROAD	150
AUNT WILLIAM ROAD	151
AUNT YOUNG ROAD	152
AUNT ZOE ROAD	153
AUNT ELIZABETH ROAD	154
AUNT MARGARET ROAD	155
AUNT ANN ROAD	156
AUNT JANE ROAD	157
AUNT MARY ROAD	158
AUNT SARAH ROAD	159
AUNT THOMAS ROAD	160
AUNT WILLIAM ROAD	161
AUNT YOUNG ROAD	162
AUNT ZOE ROAD	163
AUNT ELIZABETH ROAD	164
AUNT MARGARET ROAD	165
AUNT ANN ROAD	166
AUNT JANE ROAD	167
AUNT MARY ROAD	168
AUNT SARAH ROAD	169
AUNT THOMAS ROAD	170
AUNT WILLIAM ROAD	171
AUNT YOUNG ROAD	172
AUNT ZOE ROAD	173
AUNT ELIZABETH ROAD	174
AUNT MARGARET ROAD	175
AUNT ANN ROAD	176
AUNT JANE ROAD	177
AUNT MARY ROAD	178
AUNT SARAH ROAD	179
AUNT THOMAS ROAD	180
AUNT WILLIAM ROAD	181
AUNT YOUNG ROAD	182
AUNT ZOE ROAD	183
AUNT ELIZABETH ROAD	184
AUNT MARGARET ROAD	185
AUNT ANN ROAD	186
AUNT JANE ROAD	187
AUNT MARY ROAD	188
AUNT SARAH ROAD	189
AUNT THOMAS ROAD	190
AUNT WILLIAM ROAD	191
AUNT YOUNG ROAD	192
AUNT ZOE ROAD	193
AUNT ELIZABETH ROAD	194
AUNT MARGARET ROAD	195
AUNT ANN ROAD	196
AUNT JANE ROAD	197
AUNT MARY ROAD	198
AUNT SARAH ROAD	199
AUNT THOMAS ROAD	200

This plan reflects the Rural & State road names & road extents approved by the District Council of Cleve (Section 219 Local Government Act)

Council Delegate

Note:-  
 Rural roads within urban/town addressing areas (as shown on the Plan) will retain their historical names used for urban addressing.  
 Refer to local Council for details.  
 Roads without rural addresses may not be shown on this map.

SEALED  
 CAT 1  
 CAT 2  
 CAT 3